





**\*\*AVAILABLE AUGUST 2025\*\***

**\*\*FURNISHED\*\* \*\*OFF STREET PARKING\*\***

Located in the prestigious location of Jesmond Park West, this two bedroom apartment found on the second floor of the High Dene development. Having undergone a full refurbishment in 2017 this smart property boasts dual aspect green views, off street parking and is ideal for a professional couple or single occupant.



The property briefly comprises a communal entrance hallway with stairs to all floors. The apartment itself, modern and stylish throughout, has a large master double bedroom; a smaller second bedroom which could also double as a study if preferred; a large lounge/ diner with seated bay window and dual aspect views; a modern fitted kitchen with integrated appliances including a dishwasher; a family bathroom WC. Fully furnished, with gas central heating, double glazed windows and lovely green views from all windows!

Externally there are well kept communal gardens, one allocated off street parking space as well as off street bays for visitors parking.

Available 26th August 2025 | £950pcm |  
Furnished | Second Floor Apartment | 473 Sq ft (44 m2) | Lounge/ Diner | Modern Kitchen | Two Bedrooms | Bathroom WC | Communal Gardens | Great Location | Off Street Allocated Parking | Close To Public Transport Links | DG & GCH | Council Tax Band: C | EPC Rating: D

**GROUND FLOOR**  
473 sq. ft. (44.0 sq. m.) approx.

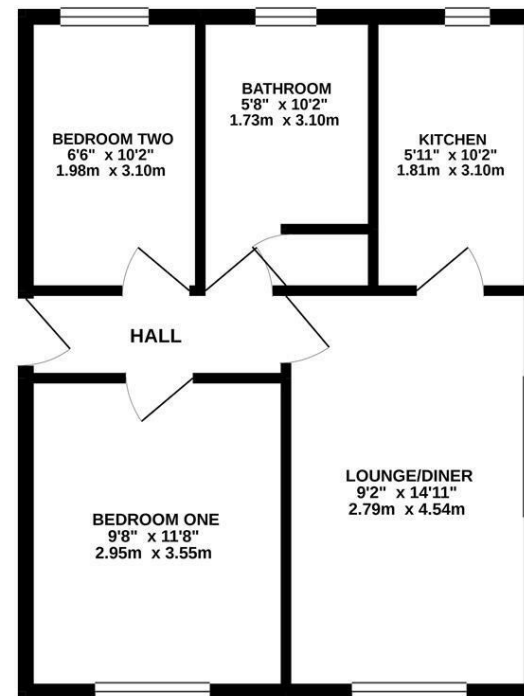

**£950 PCM**

**IMPORTANT NOTE:** These particulars and the descriptions and measurements herein do not constitute representation and whilst every effort has been made to ensure accuracy, this cannot be guaranteed.

TOTAL FLOOR AREA: 473 sq. ft. (44.0 sq. m.) approx.  
Whilst every attempt has been made to ensure the accuracy of the floorplan contained herein, measurements of doors, windows, rooms and any other items are approximate and no responsibility is taken for any error, omission or mis-statement. This plan is for illustrative purposes only and should be used as such by any prospective purchaser. The services, systems and appliances shown have not been tested and no guarantee as to their operability or efficiency can be given.  
Made with Metreplex ©2019

